



Lumber Mill Chain

WELDED STEEL CHAIN

TRANSFER CHAINS

H CLASS MILL CHAIN

81X LUMBER CHAIN

"H" CLASS

SENQCIA "H" class mill chains are extremely strong, serviceable chains originally designed for heavy drives and transfer conveyor purposes in sawmills and the paper and pulp industry. However, "H" class chain has proven itself in other industrial applications as well, especially for use in abrasive

atmospheres where heavy, rugged chain is required. Sidebars of "H" class links are reinforced with wearing shoes which strengthen and stiffen the links and provide wearing surfaces which prolong the chain's life when it is operated in troughs, over floors or runways. "T" head pins are held by two lugs cast into the side of each link to prevent pin rotation.

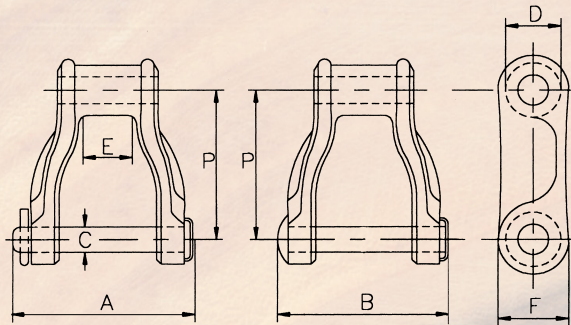
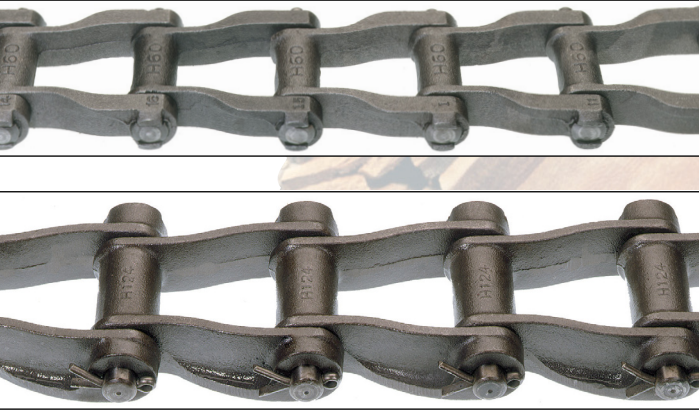

SENQCIA CHAIN NUMBER	AVERAGE PITCH IN INCHES	MAX. WORKING LOAD Lbs.	AVERAGE ULTIMATE STRENGTH Lbs.	AVERAGE WEIGHT PER FOOT Lbs.	NO. OF LINKS IN 10 FEET	DIMENSIONS - INCHES					
						A	B	C	D	E	F
H60	2.308	1,170	7,000	2.1	52	2 11/16	2 17/32	5/16	3/4	3/4	3/4
H74	2.609	1,580	10,000	3.0	46	3	2 7/8	3/8	7/8	1	1
H78	2.609	2,380	16,000	4.2	46	3 1/4	3 3/16	1/2	7/8	1 1/8	1 1/8
H82	3.075	3,080	20,000	5.5	39	4	3 7/8	9/16	17/32	1 1/4	1 1/4
H124	4.000	5,000	30,000	8.8	30	5 3/16	4 7/8	3/4	17/16	1 5/8	1 9/16

TRANSFER

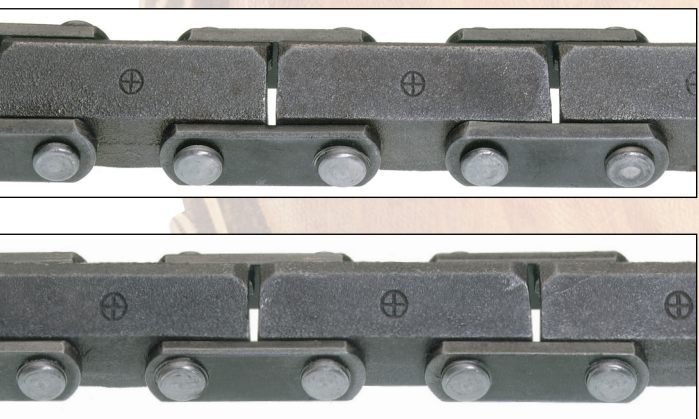

SENQCIA transfer chains are designed to carry heavy, concentrated loads such as boxes, lumber, steel shapes and barrels. They are usually installed in chain troughs with two or more parallel strands moving in the same direction, and only the tops protruding. SENQCIA transfer chains are furnished in rooftop or camel back design, with riveted construction and made of pearlitic malleable iron.

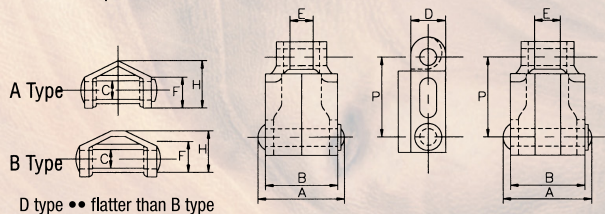

SENQCIA CHAIN NUMBER	TYPE	PITCH	MAX WORKING LOAD LBS.	AVERAGE ULTIMATE STRENGTH LBS.	AVERAGE WEIGHT PER FOOT LBS.	NO. OF LINKS IN 10 FEET	DIMENSIONS - INCHES						
							A	B	C	D	E	F	H
H-78A	A	2.609	2,380	16,000	5.7	46	3 1/8	2 3/4	1/2	7/8	1 1/8	1	1 11/16
H-78B	B	2.609	2,380	16,000	6.2	46	3 1/8	2 3/4	1/2	7/8	1 1/8	1	1 11/16
C-55A	A	1.631	1,110	9,000	3.2	74	2	1 3/16	3/8	23/32	11/16	3/4	1 1/4
C-55B	B	1.631	1,110	9,000	3.2	74	2	1 3/16	3/8	23/32	11/16	3/4	1 1/4
C-55D	••D	1.631	1,110	9,000	3.2	74	2	1 3/16	3/8	23/32	11/16	3/4	1 1/4
H-130A	A	4.000	2,110	14,000	5.2	30	3 1/4	2 13/16	1/2	1	1	1 1/8	1 5/8
H-138B	B	4.000	2,110	15,000	5.8	30	3 1/4	2 13/16	1/2	1	1	1 1/16	1 11/16

81X LUMBER CHAINS

81X Lumber Chains are available in standard, Heavy Series, HS Series, with or without attachments.

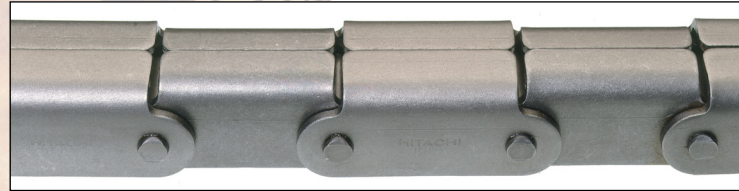
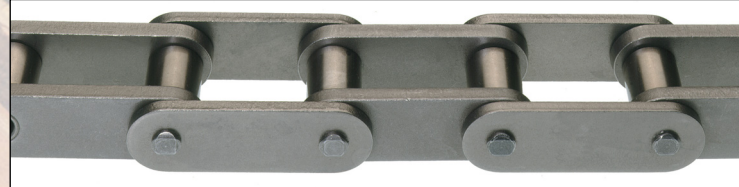
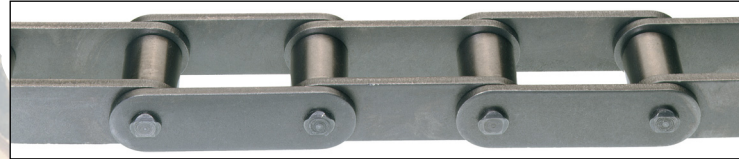
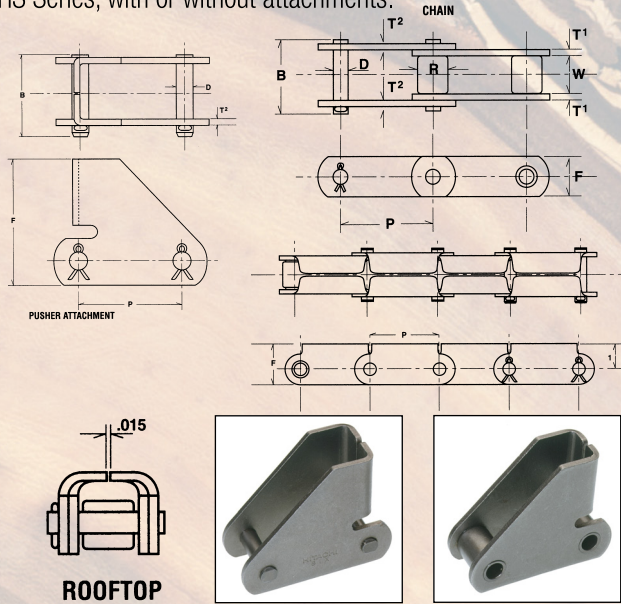

SENQCIA CHAIN NUMBER	DIMENSIONS - INCHES										
	PITCH	ROLLER		PIN	SIDE PLATE			PIN LENGTH		AVG. UTL. STRENGTH	AVG. WEIGHT PER FOOT
		DIA	WIDTH	DIA.		THICKNESS		RIV	COTT		
		P	R	W	D	F	T ₁	T ₂	A		
81X	2.609	.906	1.062	.437	1.125	.156	.156	1.890	2.063	25,000	2.6
81XH	2.609	.906	1.062	.437	1.264	.312	.219	2.376	2.496	42,000	4.5
81XHS	2.609	.906	1.062	.437	1.264	.312	.312	2.52	2.690	42,000	5.1
81X Rooftop	2.609	.906	1.062	.437	1.562	.156	.156	2.52	2.690	25,000	6.0
Pusher Attachment	2.609	.906	1.062	.437	3.125	.156	.156		2.066	25,000	1.4

WELDED STEEL

SENQCIA welded steel mill chains are recommended for most conveying, driving, and elevating applications where a high-

strength steel rollerless chain is required. These chains will operate on the same sprockets as those of the replaceable cast chains.

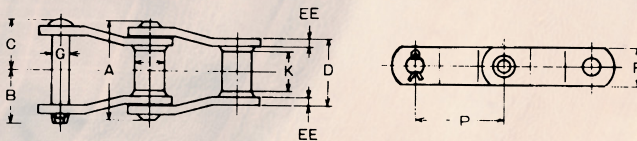

	DIMENSIONS - INCHES												
SENQCIA CHAIN NUMBER	PITCH	BARREL		PIN			SIDE BAR		LENGTH OF BEARING	AVERAGE ULTIMATE STRENGTH	MAX. WORKING LOAD	AVERAGE WEIGHT PER FOOT	
		MAX.	DIA.	DIA.	LENGTH		HEIGHT	THICKNESS					
	P	W	I	G	A	B	C	F	EE	D	Lbs.	Lbs.	Lbs.
WR78	2.609	1 1/8	7/8	1/2	2 29/32	1 5/8	1 31/64	1 1/8	1/4	2	24,000	3,000	4.0
WR82	3.075	1 17/64	1 1/16	9/16	3 3/16	1 25/32	1 5/8	1 1/4	1/4	2 1/4	26,000	3,800	4.9
WR124	4.000	1 5/8	1 7/16	3/4	4 7/64	2 25/64	2 7/64	1 1/2	3/8	2 3/4	46,000	6,300	8.5
WR132	6.050	3	1 5/8	1	6 7/64	3 25/64	3 5/32	2	1/2	4 3/8	84,000	13,100	13.4
WH78	2.609	1 1/8	7/8	1/2	2 29/32	1 5/8	1 31/64	1 1/8	1/4	2	36,000	3,500	4.0
WH82	3.075	1 17/64	11/16	9/16	3 3/16	1 25/32	1 5/8	1 1/4	1/4	2 1/4	40,000	4,500	4.9
WH124	4.000	1 5/8	17/16	3/4	4 7/64	2 25/64	2 7/64	1 1/2	3/8	2 3/4	60,000	7,350	8.5
WH132	6.050	3	1 5/8	1	6 7/64	3 25/64	3 5/32	2	1/2	4 3/8	100,000	15,000	13.4

WR = Heat Treated Pins Only
WH = All Parts Heat Treated

**Corporate Headquarters
East Coast Service Center:**

**SENQCIA MAXCO, Ltd.
1630 Cobb International Blvd.
Kennesaw, GA 30152
TEL: 800-241-8209
TEL: 770-424-9350
FAX: 770-424-9145**

West Coast Service Center:

**SENQCIA MAXCO, Ltd.
3529 NW Yeon Ave.
Portland, OR 97210
TEL: 800-544-7943
TEL: 503-228-6828
FAX: 503-228-6703**

Web Site: www.senqciamaxco.com

